

Green Laser Module

DLX-9356-13 (Under development)

Built in thermo electric control

Features

- Structure : Diode pumped solid-state green lasers (with thermo electric control)
- Lasing wavelength : 532nm
- Output power : 5mW
- Operating temperature : -10~50°C

Applications

- Leveler
- Laser pointer



Absolute maximum ratings

Parameter	Symbol	Ratings	Unit
Supply voltage	V _{CC}	-0.2 ~ +3.5	V
Input signal voltage	V _{IN}	-0.2 ~ +3.5	V
Operating temperature	T _{opr}	-10 ~ +50	°C
Storage temperature	T _{stg}	-20 ~ +60	°C

Specifications ^{1) 2)}

Parameter	Symbol	Condition	Min	Typ	Max	Unit
Wavelength	λ_P		531	532	533	nm
Output power	P _o		4.5	—	5	mW
Power stability	ΔP_o	T _{opr} =-10 ~ +50 °C			±10	%
M ²	M ²				1.2	
Beam diameter	2w _r	$\Delta l = 1 \text{ m}^{3)}$	2.3	2.6	2.9	mm
Beam divergence	2 θ_r		0.3	0.35	0.4	mrad
Beam ellipticity	E _r	$\Delta l = 1 \text{ m}^{3)}$			1.2	

1)Initial values 2)Each value is measured by using our measuring instrument 3) Δl :The distance from laser beam window

External Appearance Dimension

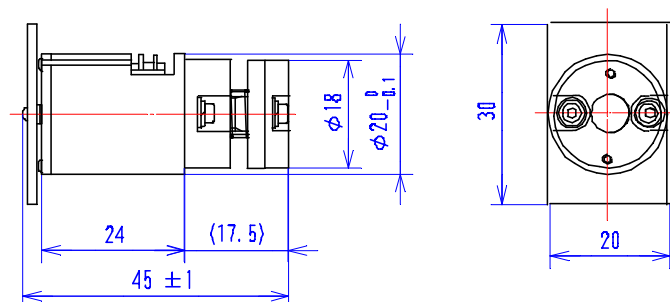

Unit : mm

Note: Product specifications are subject to change without notice.

Distributed by

IMM Meßtechnologie GmbH
Ohmstraße 4, D-85716 Unterschleißheim

Tel.: +49 89 321412-0
Fax: +49 89 321412-11

info@imm-laser.de
www.imm-laser.de

Ratings

Parameter		Symbol	Ratings	Unit
Source Voltage		V _{CC}	2.4 ~ 3.3	V
Input signal voltage	H level (Laser ON)	V _{IH}	(V _{CC} - 0.4) ~ V _{CC}	V
	L level (Laser OFF)	V _{IL}	0 ~ 0.4	V
Input impedance		R _i	10 ± 1	kΩ

Input/Output lead pin

Pin No.	Symbol	Explanation
1	V _{CC}	Supply input
2	GND	GND
3	V _{IN}	ON/OFF signal input

Typical characteristics

Power stability vs. Case temperature

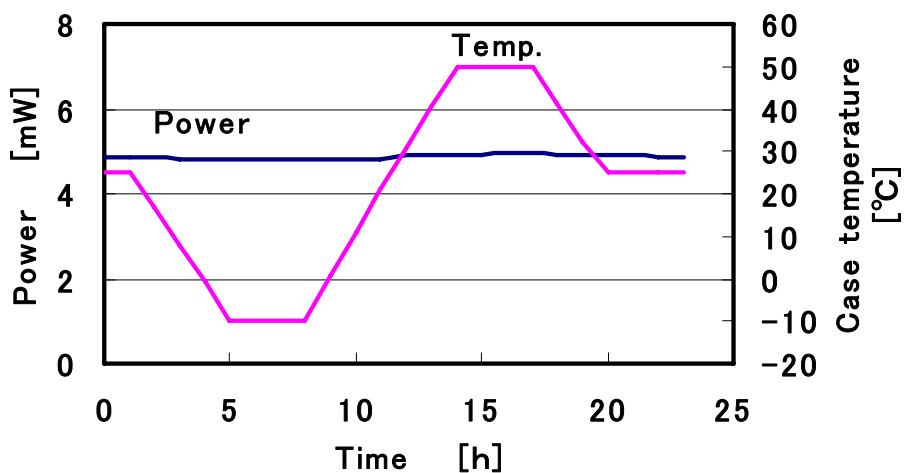

Beam diameter vs. Distance

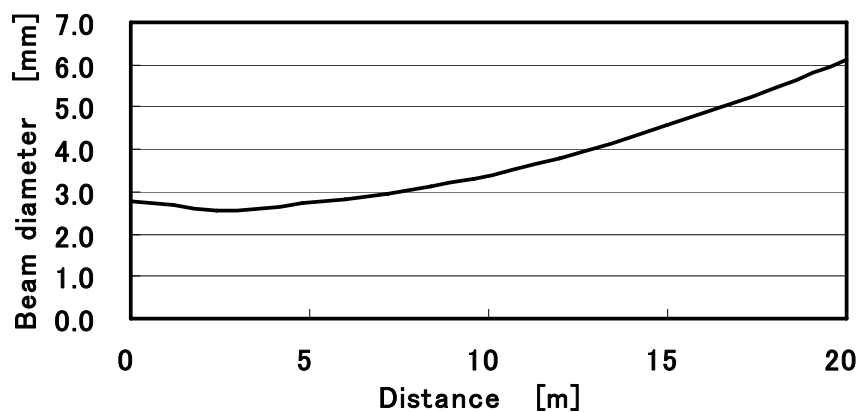

Current consumption vs. Case temperature

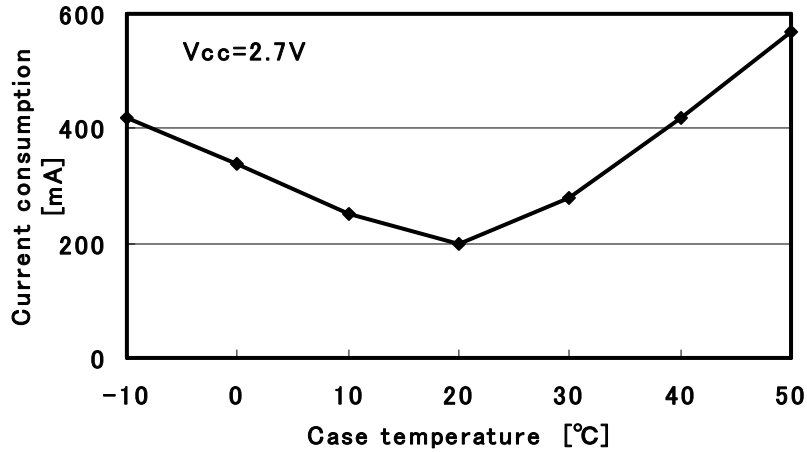

Laser classify

This product is classified into Class 3B (Maximum power : 100mW/Wavelength : 532nm)

Cautions

This laser product is classified into 3B. In the case of using, please refer to IEC60825-1:2001

