



# Electro Optical Components, Inc.

5460 Skylane Boulevard, Santa Rosa, CA 95403

Toll Free: 855-EOC-6300

[www.eoc-inc.com](http://www.eoc-inc.com) | [info@eoc-inc.com](mailto:info@eoc-inc.com)



## Pico-Second Seed Laser for Medical Beauty



500ps, 180μJ  
350ps, 150μJ  
Seed Laser



Isolator

### Key Features

- ◆ Excellent power stability <2%
- ◆ Sealed package, high reliability
- ◆ Excellent beam quality - TEM<sub>00</sub>
- ◆ Wide operating temperature: 10~45°C
- ◆ Aperture size: 2.5mm, 4.5mm optional
- ◆ Extremely long life time to 7000 billion shots
- ◆ Multiple energy amplification technologies optional ( amplification energy output >750mJ)

### Applications

- ◆ Seed laser of aesthetic system for tattoo and pigment removal

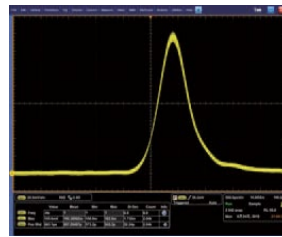

Typical Pulse

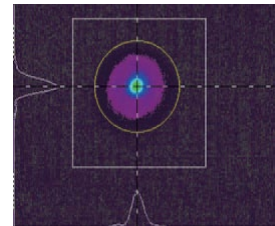

Beam Profile

Optical Parameter	
Part No.	MCB-1064-0.01-180    MCD-1064-0.01-150
Repetition rate(Hz)	1~20 Optional
Wavelength (nm)	1064
Pulse width(ps)	500                      350
Pulse energy(μJ)	180                         150
Power stability	r 3%
Beam profile	TEM <sub>00</sub>
Beam (mrad)	Horizontal@@1/e <sup>2</sup> Typ.8
	Vertical@1/e <sup>2</sup> Typ.8
Polarization (dB)	>100:1
System Parameter	
Supply power voltage	100-240 VAC,50/60Hz
Modulation input	TTL 0-5V, BNCinput
Control interface	Serial interface
Power consumption(W)	<20W
Storage humidity	10-80%RH
Power dimensions (W H L,	150X76X145
Laser head dimensions (W H L,	45x30x120
Operating temperature (°C)	10-40
Storage temperature (°C)	0-50

### Isolator

Part No.	Aperture size (mm)	Wavelength (nm)	Isolation@25°C	Transmittance
RISO-1064-4.5	4.5	1064	>30dB	>90%
RISO-1064-2.5	2.5	1064	>30dB	>90%

Mechanical Specifications

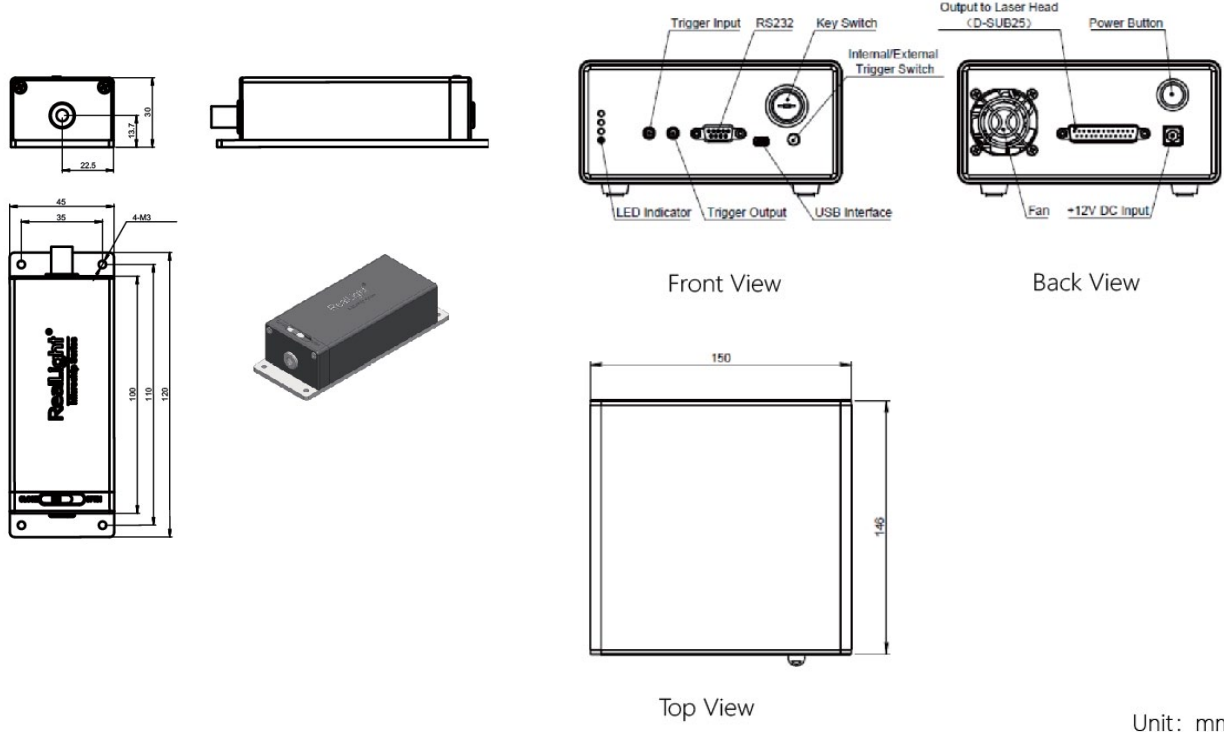

Unit: mm

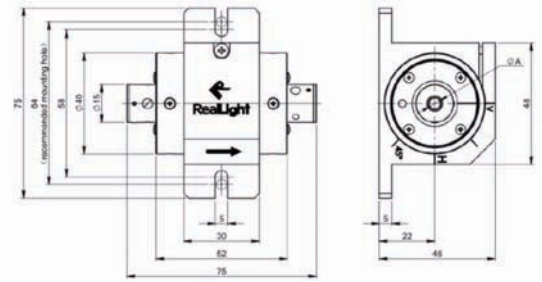

2.5&4.5mm Isolator

Diode Laser Components for Physical Therapy Optional



Wavelength	808nm	980nm	808nm+980nm	638nm+808nm+915nm+980nm
Power	7W	10W	15W+15W	0.2W+8W+10W+10W
	15W	15W		
Fiber Core	200µm	200µm	400µm	400µm
Numerical Aperture	0.22			
Output Configuration	Aiming beam, thermistor, photodiode, TEC, fiber detector			

\*Other packages and wavelengths are available upon request.